

Limited production model.

For availability, please email customerservice@mtibaths.com or call 800-783-8827

DESIGNER COLLECTION TUBS
MODEL # 66



Primm

65.5" x 41.5" x 26.75"

GENERAL SPECIFICATIONS:

Material - Acrylic

Installation - Freestanding

Not recommended as a tub / shower combination.

Soaker Weight - 200 lbs / 57 kg

Maximum Fill - 94 gal to overflow

NOTE: Filling this tub to the maximum may require an above average size or dedicated water heater.

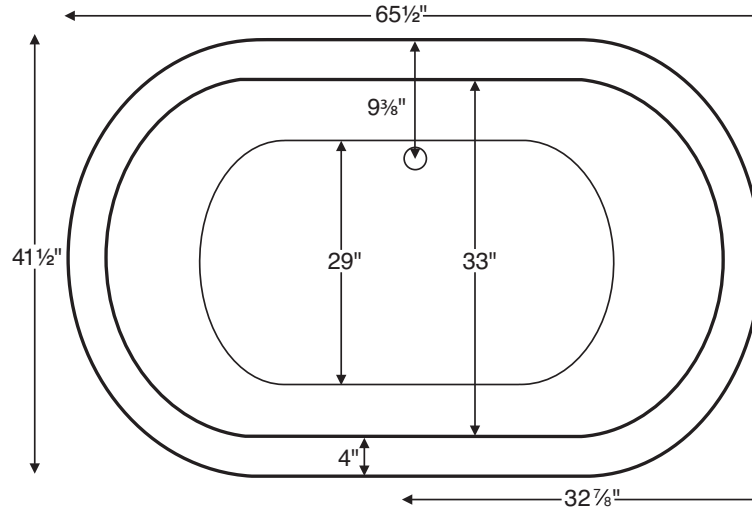

Requires use of a wall-mounted or freestanding tub filler.

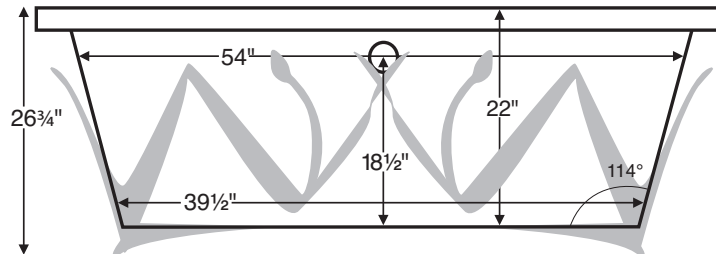

IMPORTANT ORDERING & INSTALLATION INFORMATION:

- The handcrafted wrought iron base, in natural finish, includes variations in tone and texture, which are intrinsic to the material itself and contribute to its overall rustic beauty.
- If a smoother, more consistent finish is desired, the base may be ordered with a powder-coat finish, available in Bronze Rock, Flat Black or Gloss Black. *Must specify on order.*
- Specifications and configurations are subject to change without notice.
- Measurements are $\pm 1/2"$ and are subject to change without notice.
- Measurements herein supersede all others published prior to publication date shown below.



See the "Designer Collection Tubs Installation & Operation Manual" included with tub delivery or go to mtibaths.com/support/installation_operation/manuals for all the information necessary to install and operate the tub.

MTI's Customer Service Department is available Monday-Friday 8am-6pm EST at 800-783-8827 or customerservice@mtibaths.com to answer any questions pertaining to ordering or installation.

Hydrotherapy Package	Package Contents	Part #	MSRP
Soaker	Soaking bath with wrought iron cattails sculptured base. Designed by local Atlanta artist Dennis Primm, this unique bath is available as a soaking bath only. (Call for lead time)	S66	\$5,600

Lead Time - Please call MTI at 800-783-8837 or email customerservice@mtibaths.com

Standard Options
Color: White (CWH) This tub is only available in white.
Textured, Slip-Resistant Bottom - meets ASTM F-462-1994 (TXBTM) \$70
Accessories & Hardware
Floor-Mounted High-Flow Tub Filler - two designs available - see p. C-16 Contemporary - Chrome (FILLC) \$1,900 ; Brushed Nickel (FILLBN) \$2,050 Traditional - Chrome (FILLTC) \$1,900 ; Brushed Nickel (FILLTBN) \$2,050
Drain Kit - Toe-Tap with Decorative Exposed Piping Chrome (DKFTC) \$886 ; Brushed Nickel (DKFBN) \$949 ; Special Finishes (DKFTSF) \$1,995 (send in finish sample for plating)
Pillows - from \$115 see p. C-14
Teak Tub Tray - Slatted (TK-TRAY1) or Solid (TK-TRAY2) \$395 see p. C-15

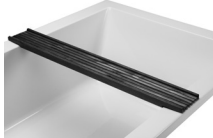
Options Information
<p>Floor-Mounted High-Flow Tub Filler - Choose from contemporary or traditional design to complement most manufacturers' lavatory & shower faucets. Fill rate of 15 gallons per minute at 45 psi. Includes hand-held shower with independent valve. See page C-16 for detailed specifications.</p> 
<p>Drain & Overflow Kit - Toe-Tap design with decorative exposed piping. MTI recommends its drain to ensure a perfect fit. Available in chrome, brushed nickel, polished nickel or special finishes*. *Send finish sample to MTI for matching.</p> 
<p>Teak Tub Tray - Ideal surface for holding a book, beverage or bath accessories. Two styles available. See page C-15 for detailed specifications.</p> 



Inside view of tub.